



JP0223

FEATURE HIGHLIGHTS

- ☞ Effortless sliding operation with large rollers assembly on a stainless steel
- ☞ Strong 15x40mm track offers stable sliding action
- ☞ Handle with strength, durability and resistance to rust and corrosion

SPECIFICATIONS

Dimension(60 in. W x 76 in. H)

- ☞ Fits 56" to 60" finished opening
- ☞ Up to 4" (102mm) in width adjustment
- ☞ Custom made is available

Glass

- ☞ 3/8 in. (10mm) thick or 5/16 in.(8mm) tempered glass
- ☞ ANSI certified tempered glass

Hardware

- ☞ Aluminum U channel as wall profile for uneven wall
- ☞ #304 stainless steel wheel with out-of-center adjustment
- ☞ Anti-splash slim aluminum threshold to prevent water spills
- ☞ #304 stainless steel handle
- ☞ Hardware finished in Chrome, Brushed, Black



Chrome

Brushed

Black

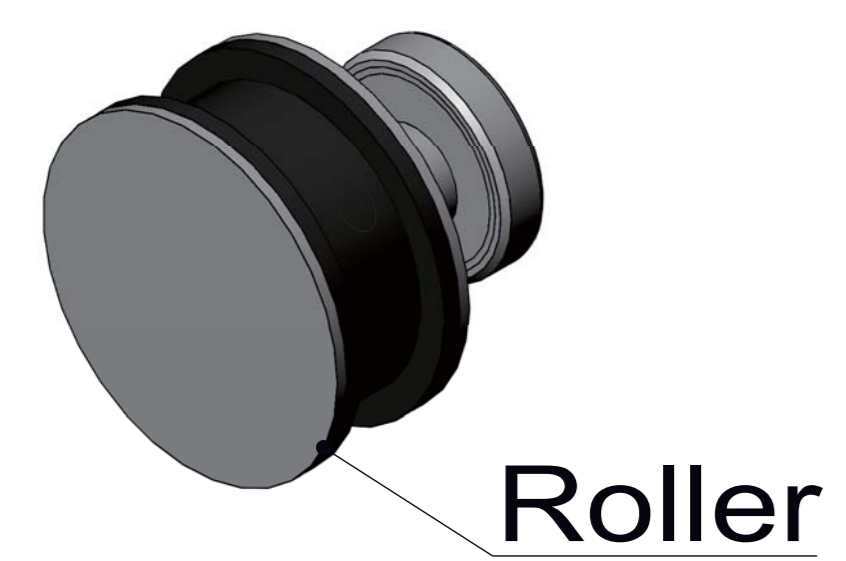

Roller



Anti-Jump Assembly

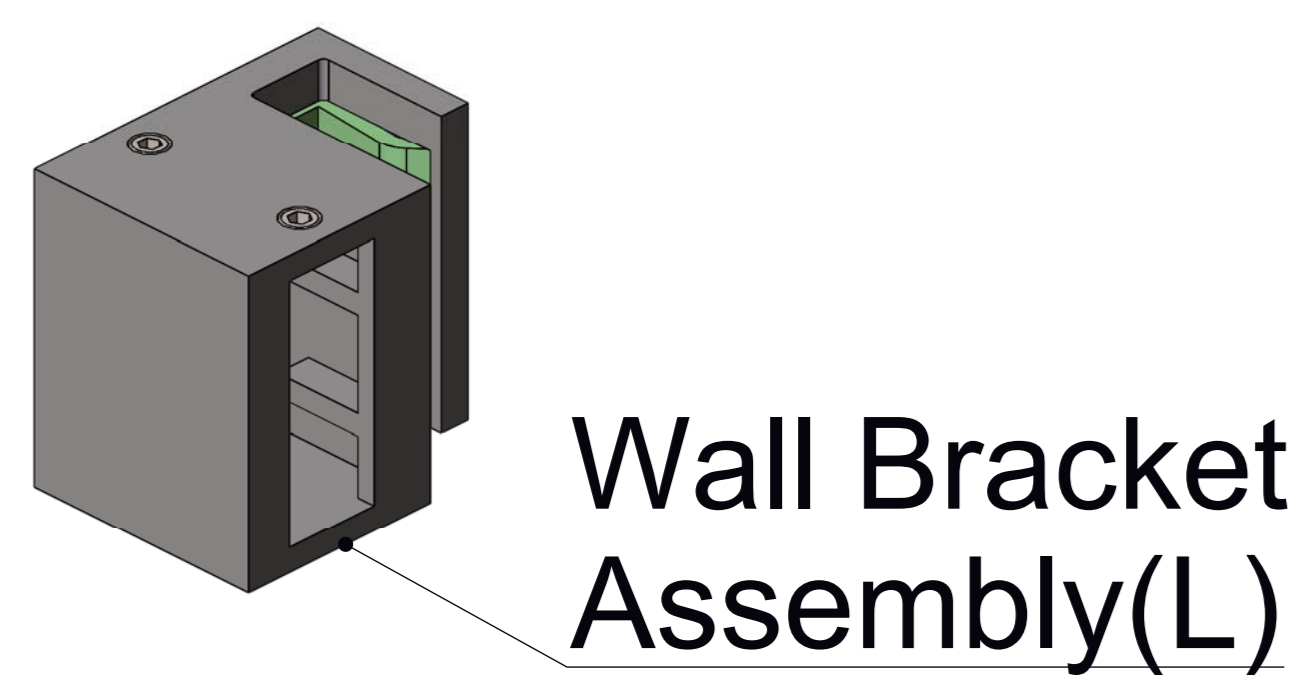

Wall Bracket Assembly(L)

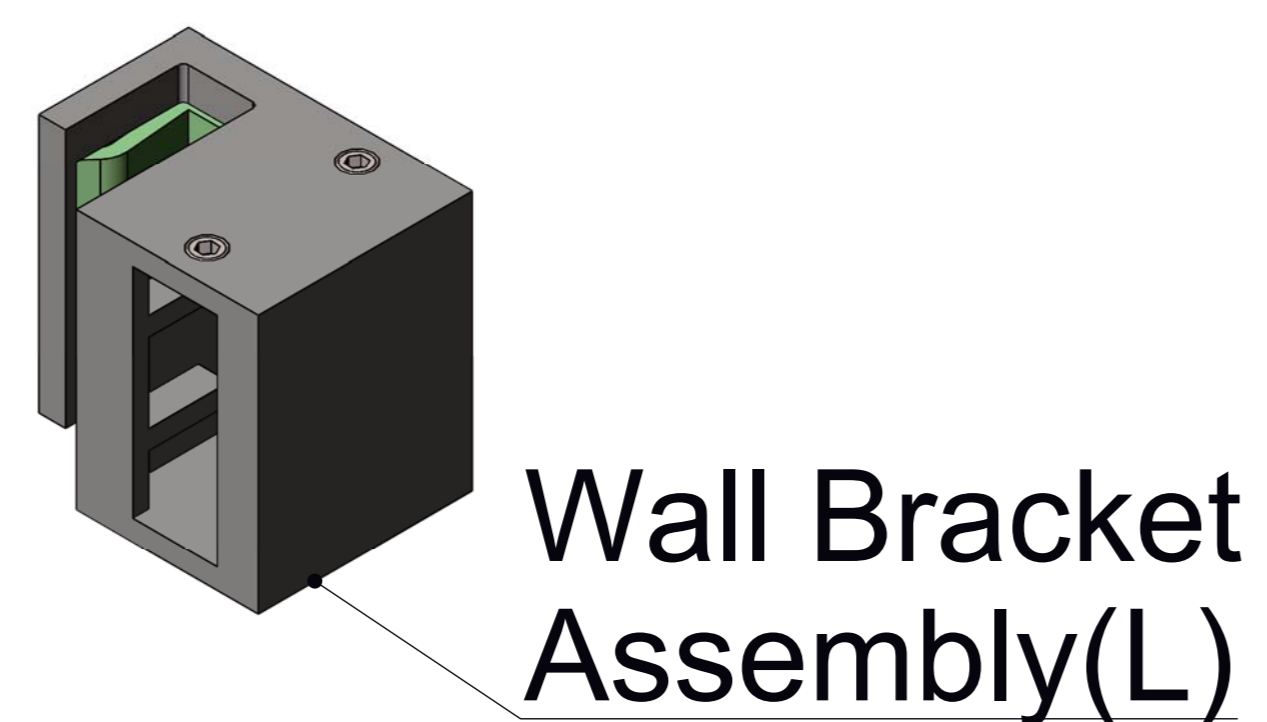

Wall Bracket Assembly(L)

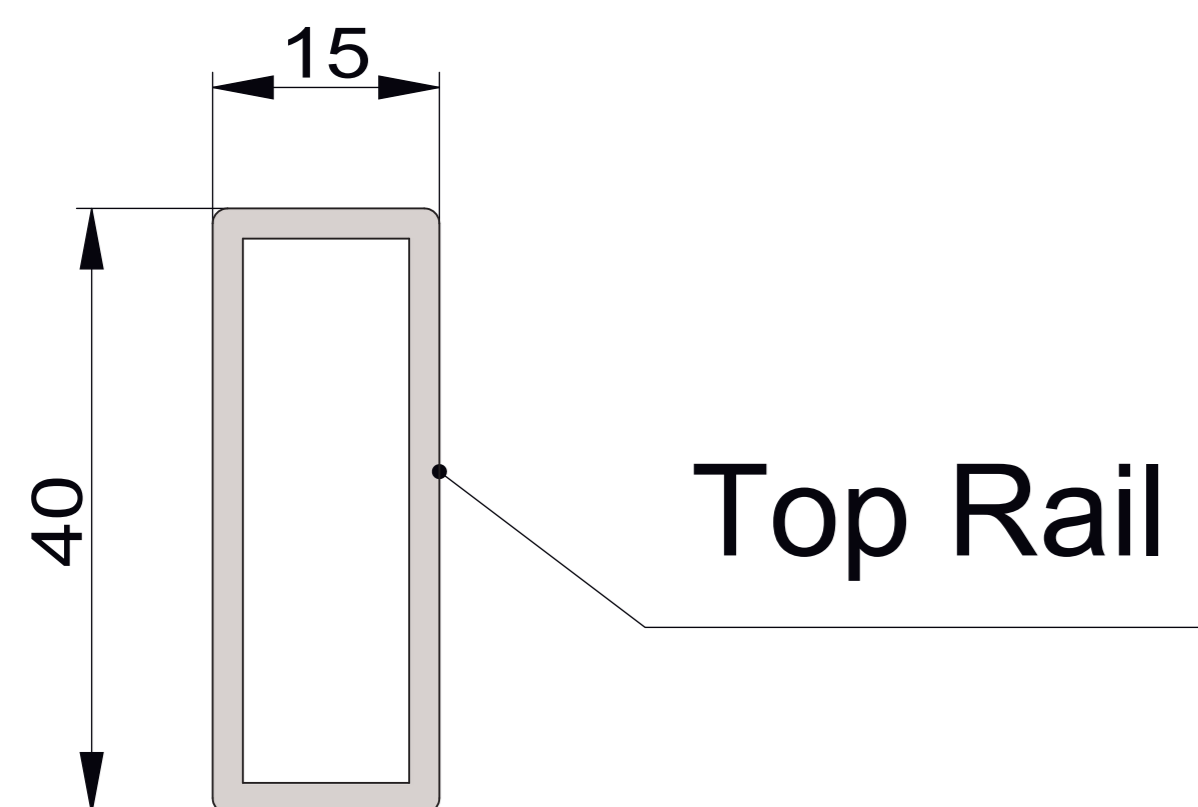

Top Rail



Anti Jumping Knob

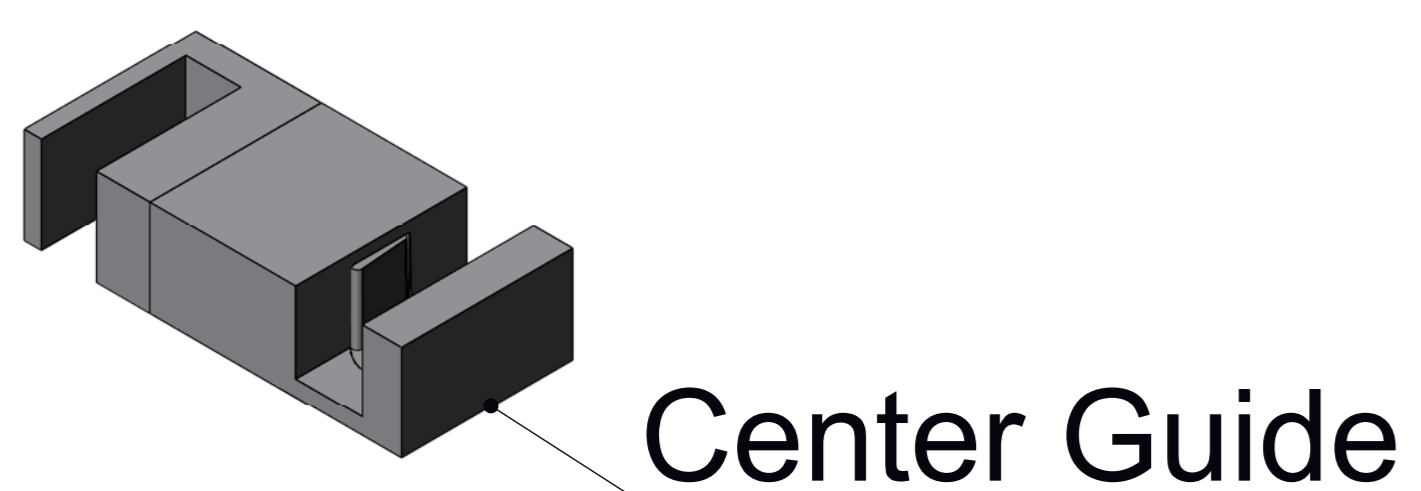

Center Guide

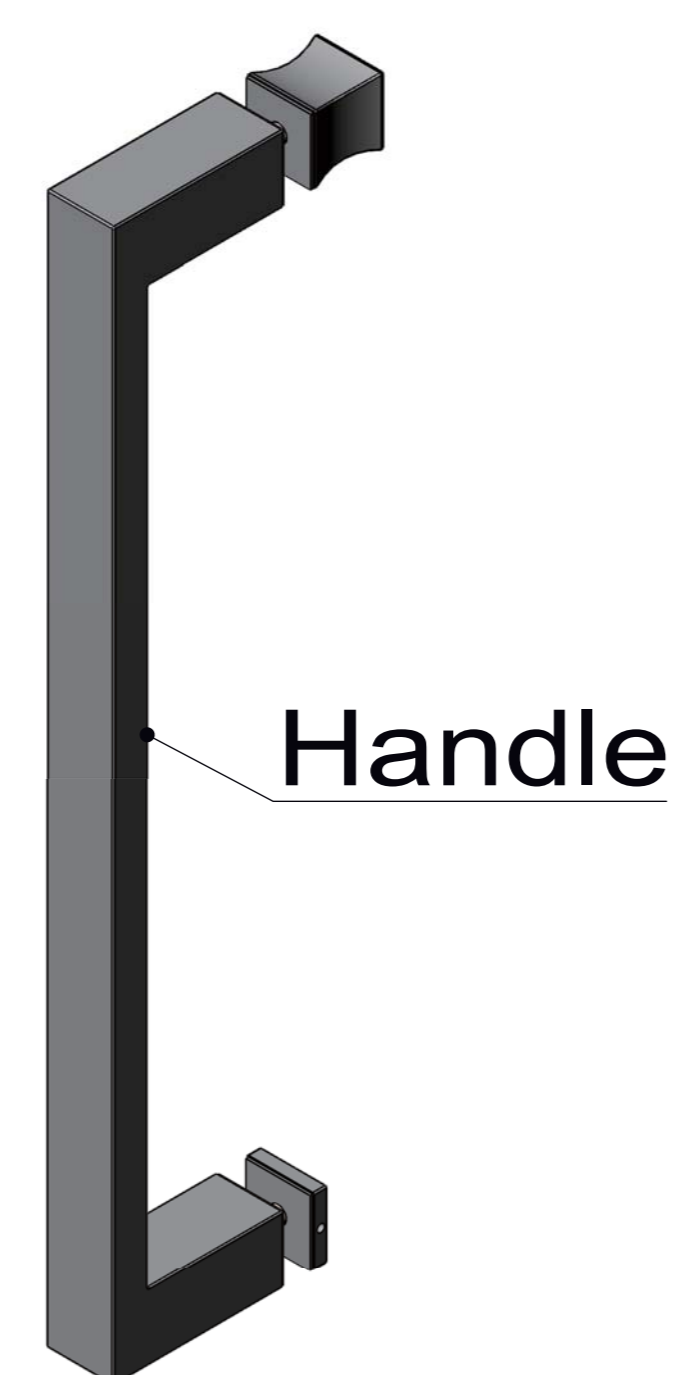

Handle

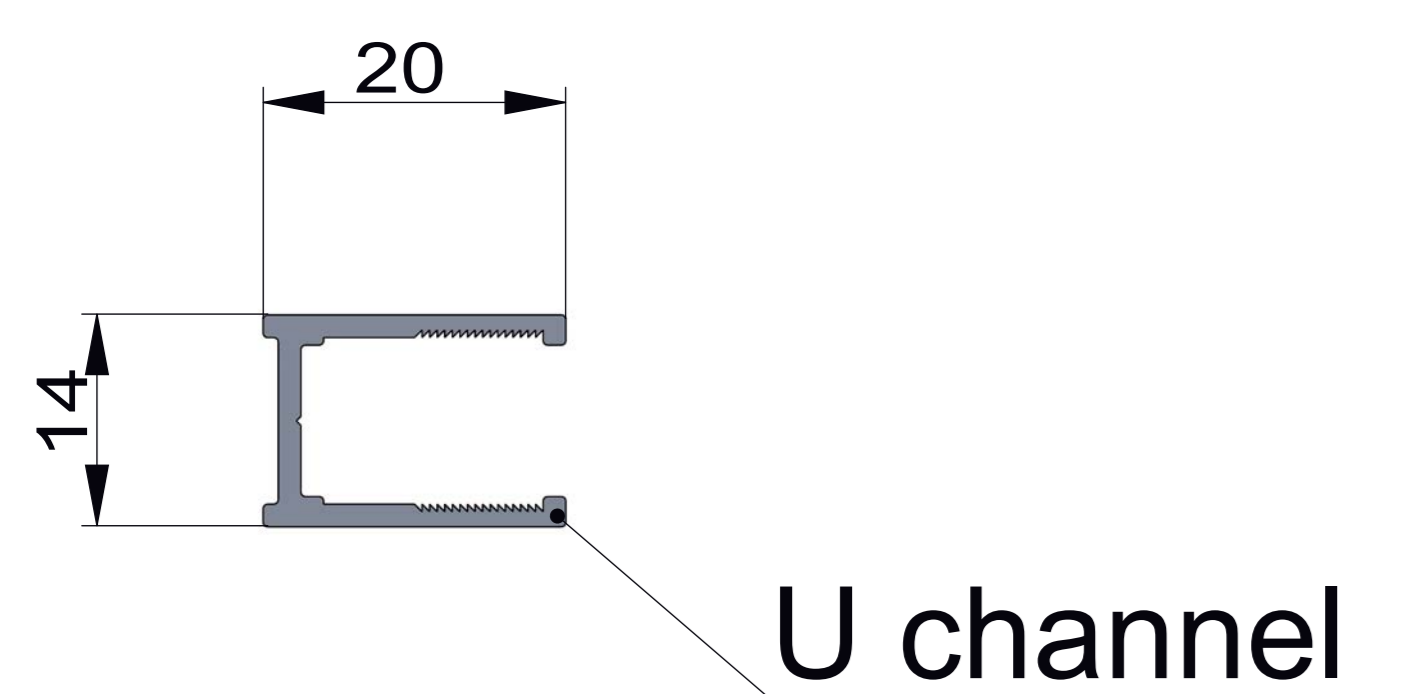

U channel

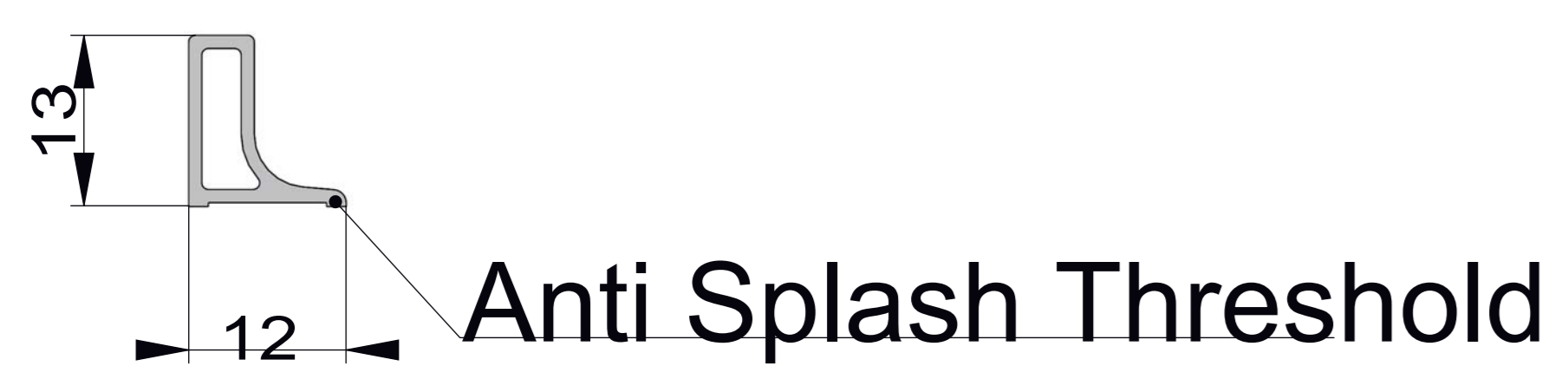

Anti Splash Threshold

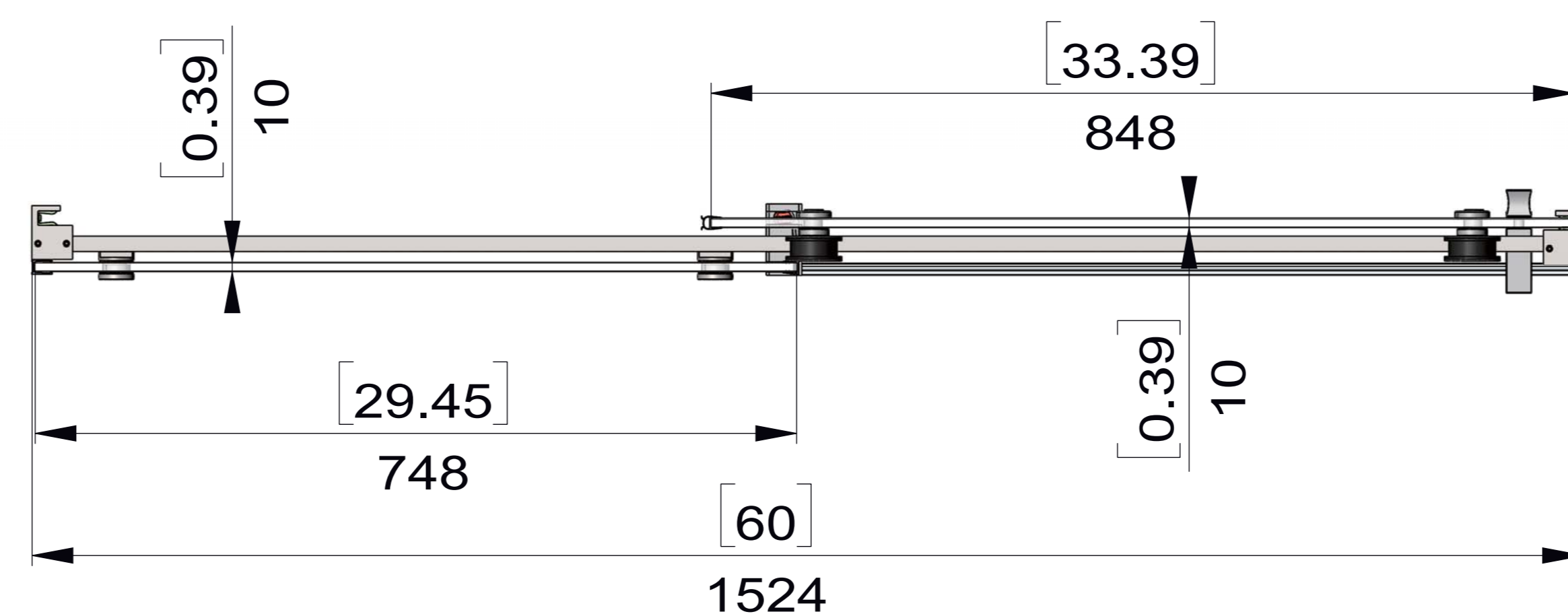
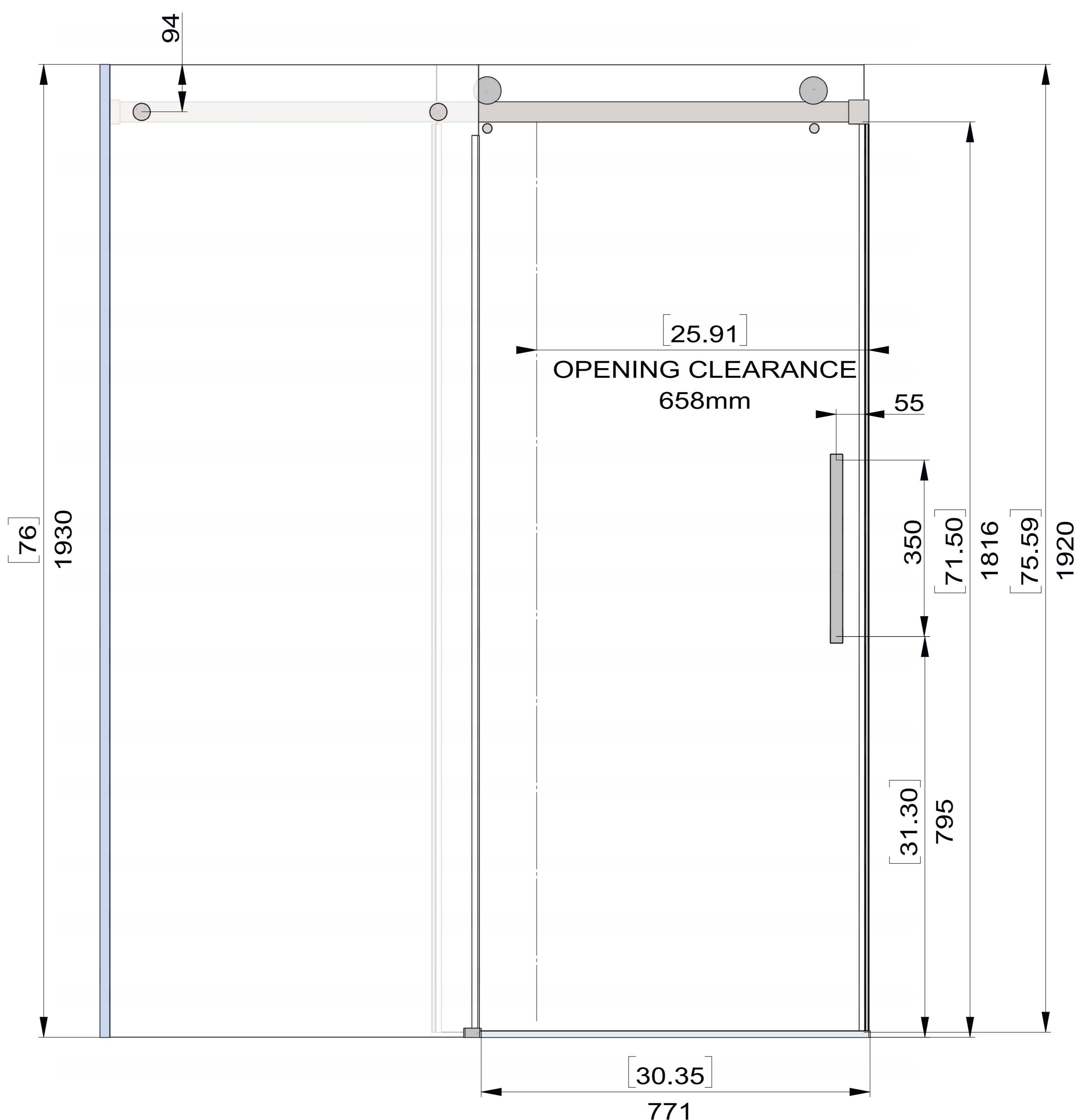

JP0223(60"X76")